

**This electronic collection of documents is provided
for the convenience of the user
and is Not a Certified Document –**

**The documents contained herein were originally issued
and sealed by the individuals whose names and license
numbers appear on each page, on the dates appearing
with their signature on that page.**

**This file or an individual page
shall not be considered a certified document.**

PROJ. REFERENCE NO.	SHEET NO.
17BP.14.R.177	X-1A

STATE OF NORTH CAROLINA DIVISION OF HIGHWAYS

CROSS-SECTION SUMMARY

NOTE: EMBANKMENT COLUMN DOES NOT INCLUDE BACKFILL FOR UNDERCUT

STATION -L-	UNCL. EXC. (CY)	UN. EMBT. (CY)
10+95.00	0	0
11+00.00	0	0
11+25.00	14	1
11+50.00	33	2
11+75.00	48	3
12+00.00	63	6
12+25.00	49	9
12+50.00	23	12
12+75.00	11	11
13+00.00	9	6
13+25.00	15	7
13+50.00	22	7
13+75.00	34	2
14+00.00	34	5
14+25.00	14	12
14+50.00	0	13
14+73.70	16	6
15+26.30	9	6
15+50.00	9	6
15+75.00	6	7
16+00.00	15	2
16+25.00	27	0
16+50.00	58	0
16+75.00	119	2
17+00.00	112	11
17+25.00	33	33
17+50.00	11	52
17+75.00	39	44
18+00.00	83	34
18+25.00	106	25
18+50.00	75	10
18+75.00	39	5
19+00.00	22	2
19+25.00	8	0
19+26.00	0	0

STATION -DR1-	UNCL. EXC. (CY)	UN. EMBT. (CY)
10+10.00	0	0
10+25.00	1	12
10+50.00	27	0
10+75.00	39	0
11+00.00	21	0
11+25.00	9	0
11+50.00	8	0
11+70.00	8	0

STATION -DR2-	UNCL. EXC. (CY)	UN. EMBT. (CY)
10+10.00	0	0
10+25.00	6	1
10+50.00	0	71
10+75.00	0	108
11+00.00	6	38
11+25.00	12	0
11+50.00	10	0
11+72.00	10	0

Approximate quantities only. Unclassified excavation, borrow excavation, fine grading, clearing and grubbing, and removal of existing pavement will be paid for at the lump sum price for "Grading".

6/23/16
I:\30\2021\188360\188360.dwg - 2015 W Divisions Planning & Design On-Call\1188360C Group 3 Bridges\17BP.R177.430237\Roadway\CorridorModeling\17BP.R177.430237_rdy_XPL_L.dgn

	PROJ. REFERENCE NO.	SHEET NO.
	17BP.14.R.177	X-1

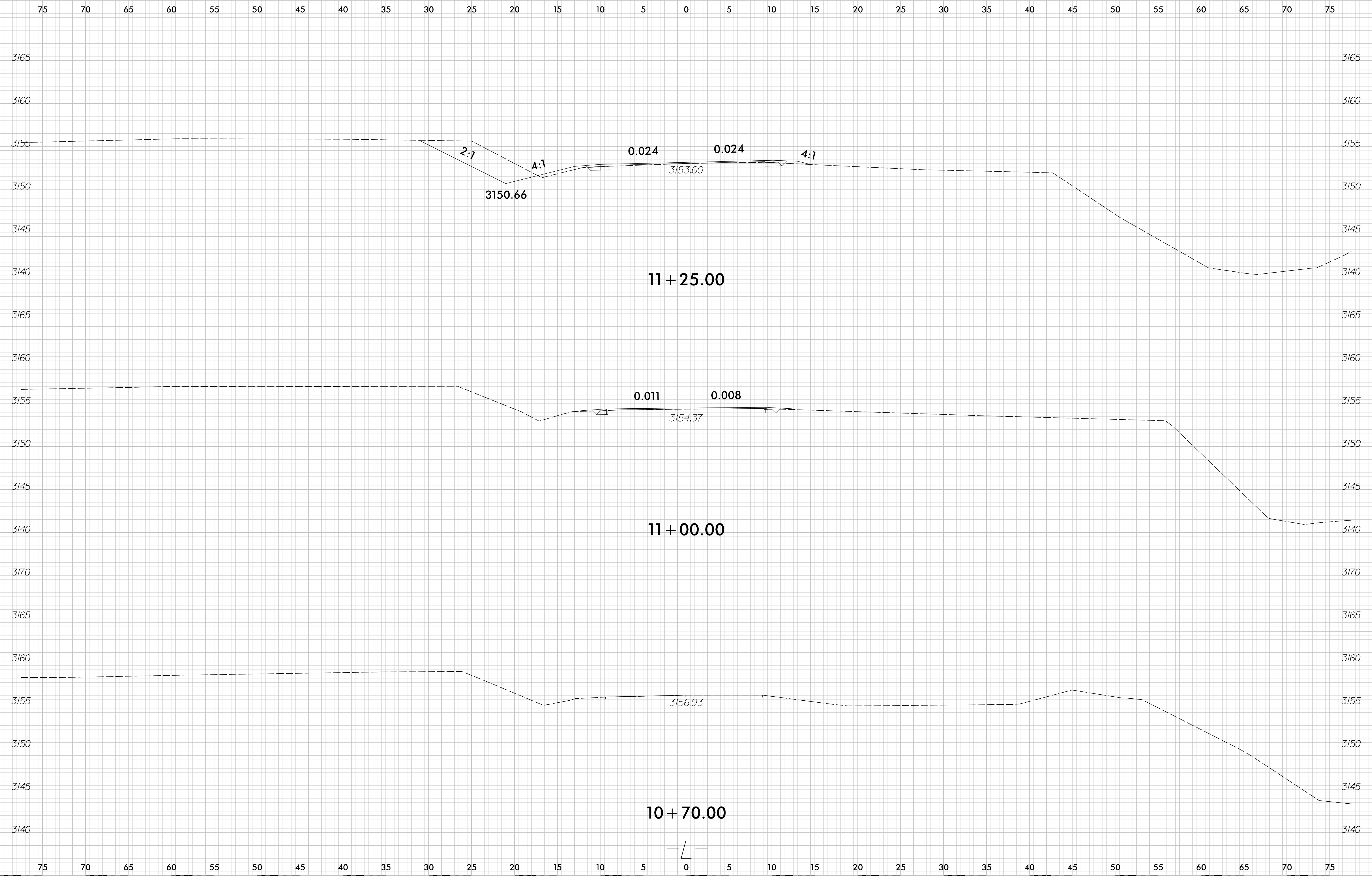

6/23/16

	PROJ. REFERENCE NO.	SHEET NO.
	17BP.14.R.177	X-2

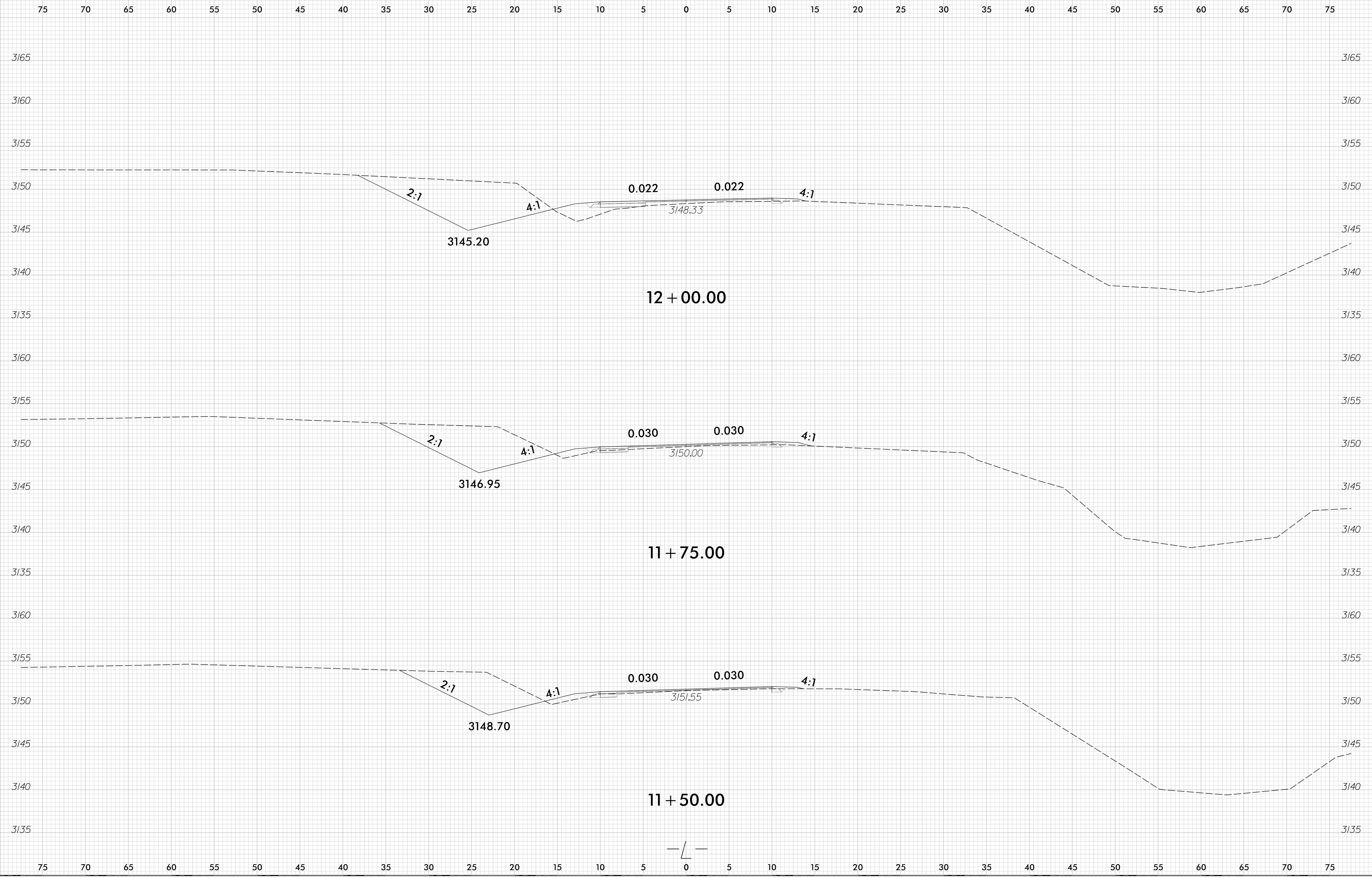

7/8/2019
D:\Projects\17BP.14.R.177\430237_rdy_XPL_L.dgn
10:04:40

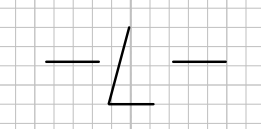

6/23/16

	PROJ. REFERENCE NO.	SHEET NO.
	17BP.14.R.177	X-3

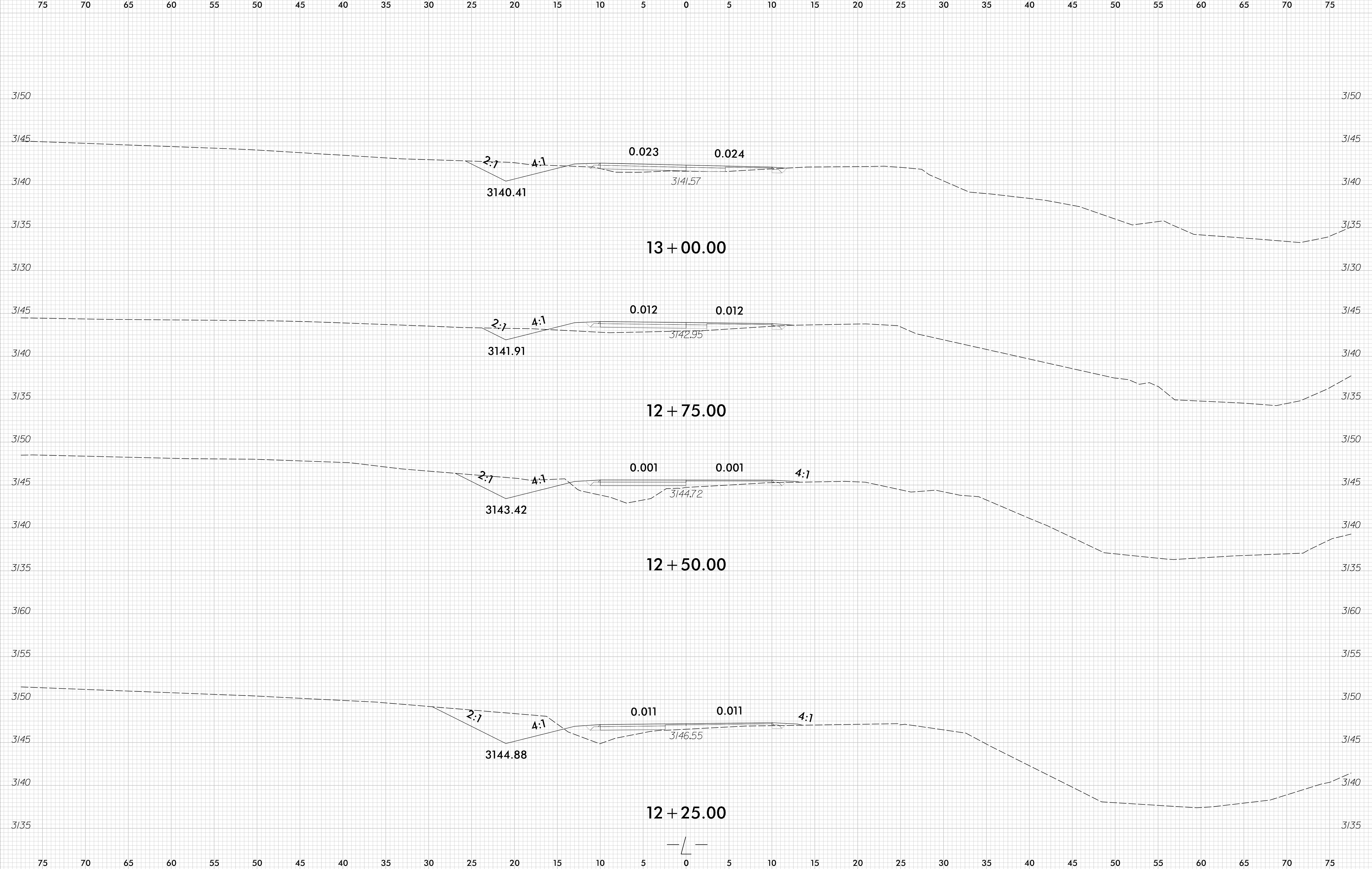

7/8/2019 10:14:40 AM C:\ProgramData\Bentley\MapGuide\CorridorModeling\17BP.R177.430237.rdy.XPL.L.dgn

6/23/16

	PROJ. REFERENCE NO.	SHEET NO.
	17BP.14.R.177	X-4

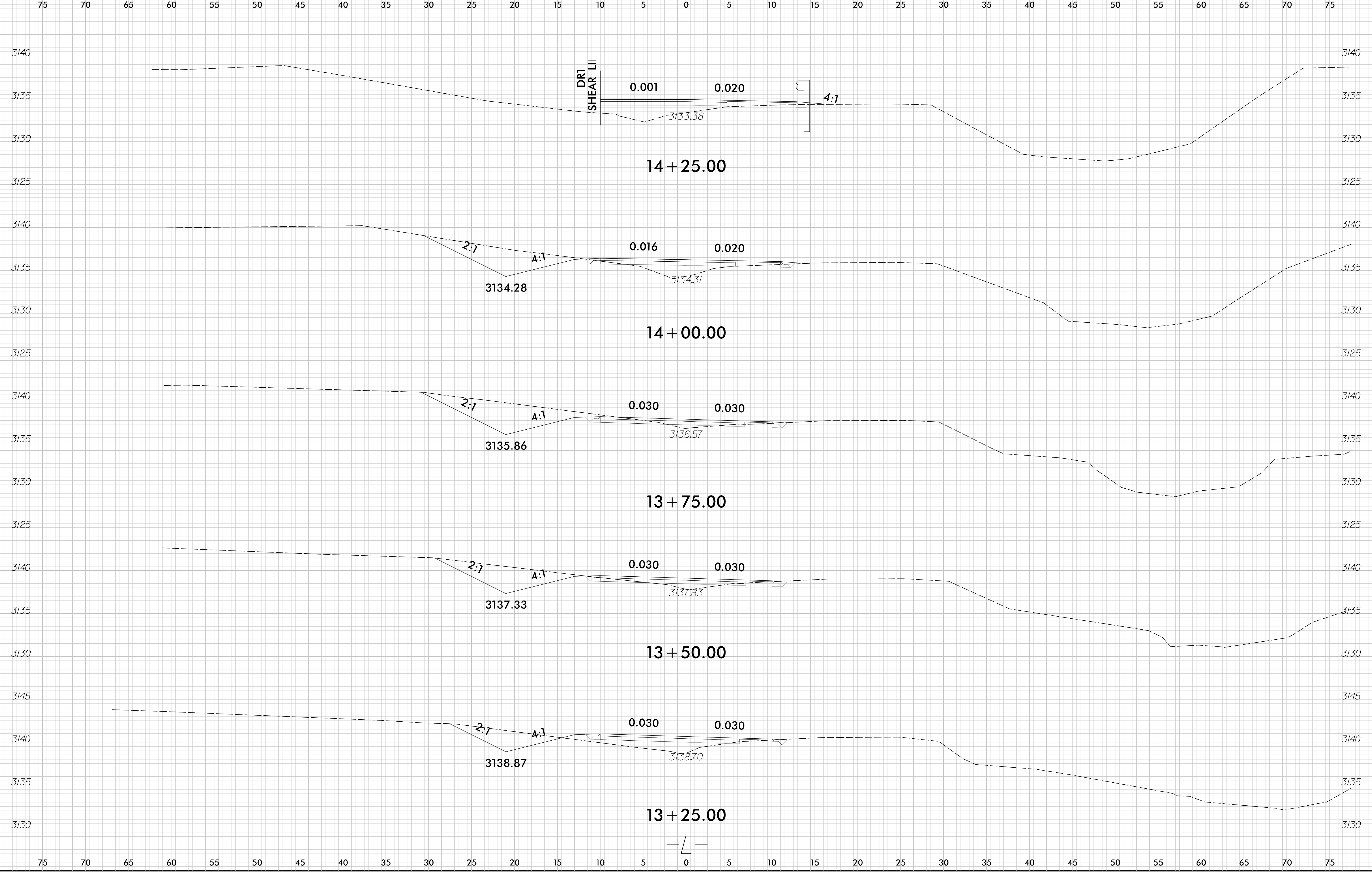

7/8/2019
C:\ProgramData\Autodesk\CorridorModeling\17BP.R177.430237.rdy.XPL.L.dgn
10:02:40

6/23/16
I:\1\2015\11883600 - 2015 W Divisions Planning & Design On-Call\11883600 Group 3 Bridges\17BP.R177.430237\Roadway\CorridorModeling\17BP.R177.430237_rdy_XPL_L.dgn

	PROJ. REFERENCE NO.	SHEET NO.
	17BP.14.R.177	X-5

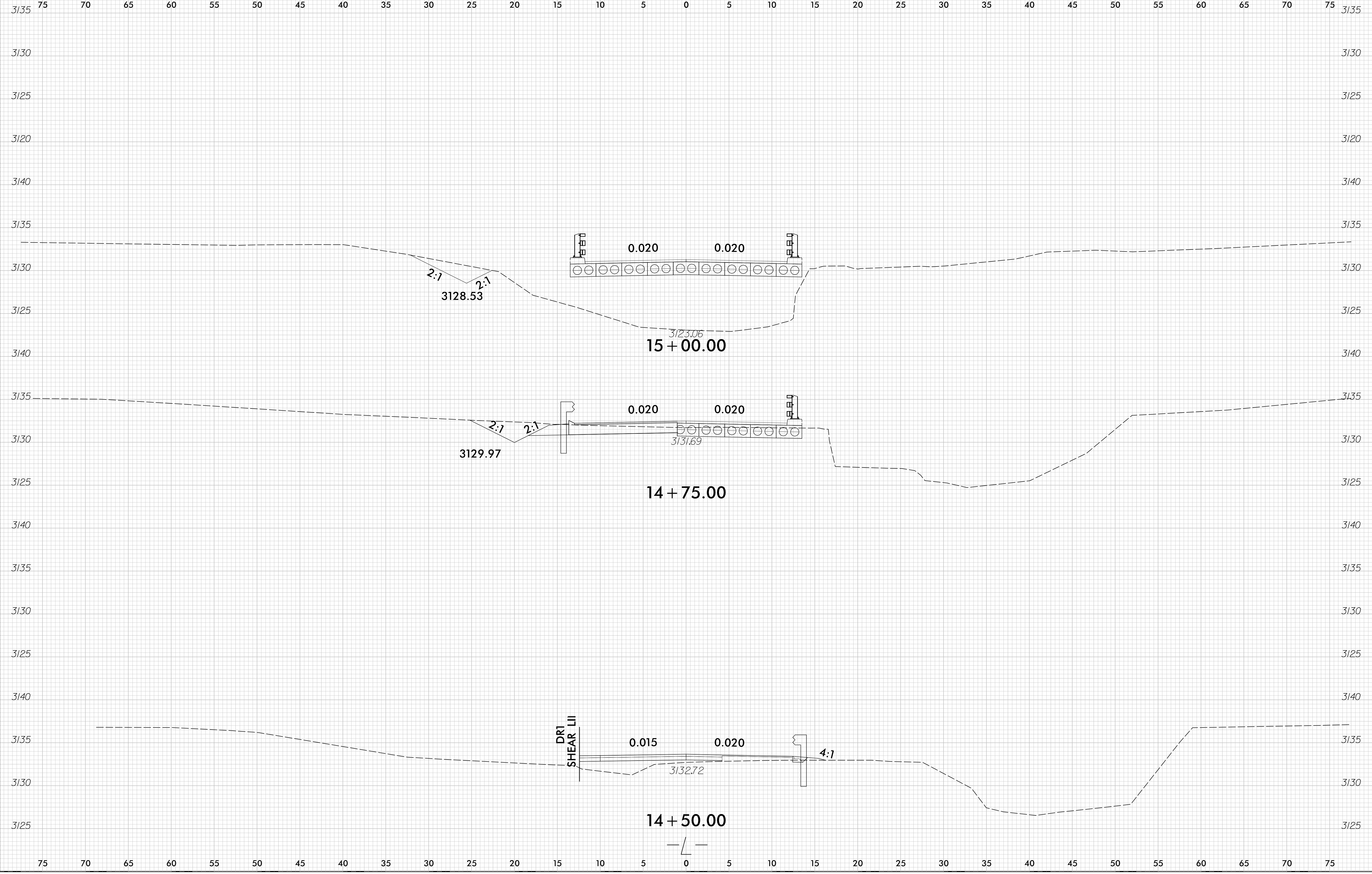

6/23/16

	PROJ. REFERENCE NO.	SHEET NO.
	17BP.14.R.177	X-6

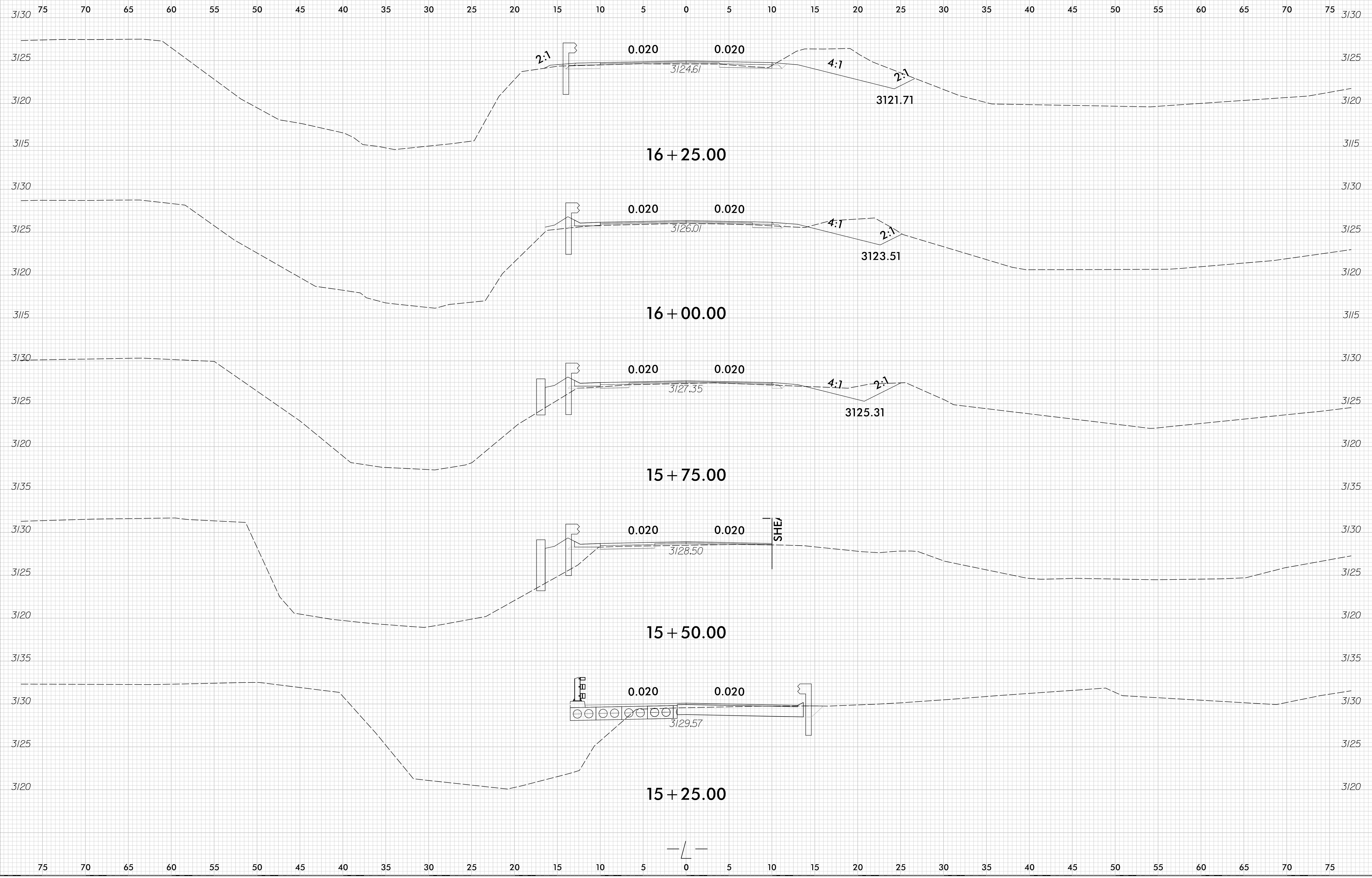

7/8/2019
C:\ProgramData\Bentley\CorridorModeling\17BP.R177.430237_rdy_XPL_L.dgn

6/23/16

	PROJ. REFERENCE NO.	SHEET NO.
	17BP.14.R.177	X-7

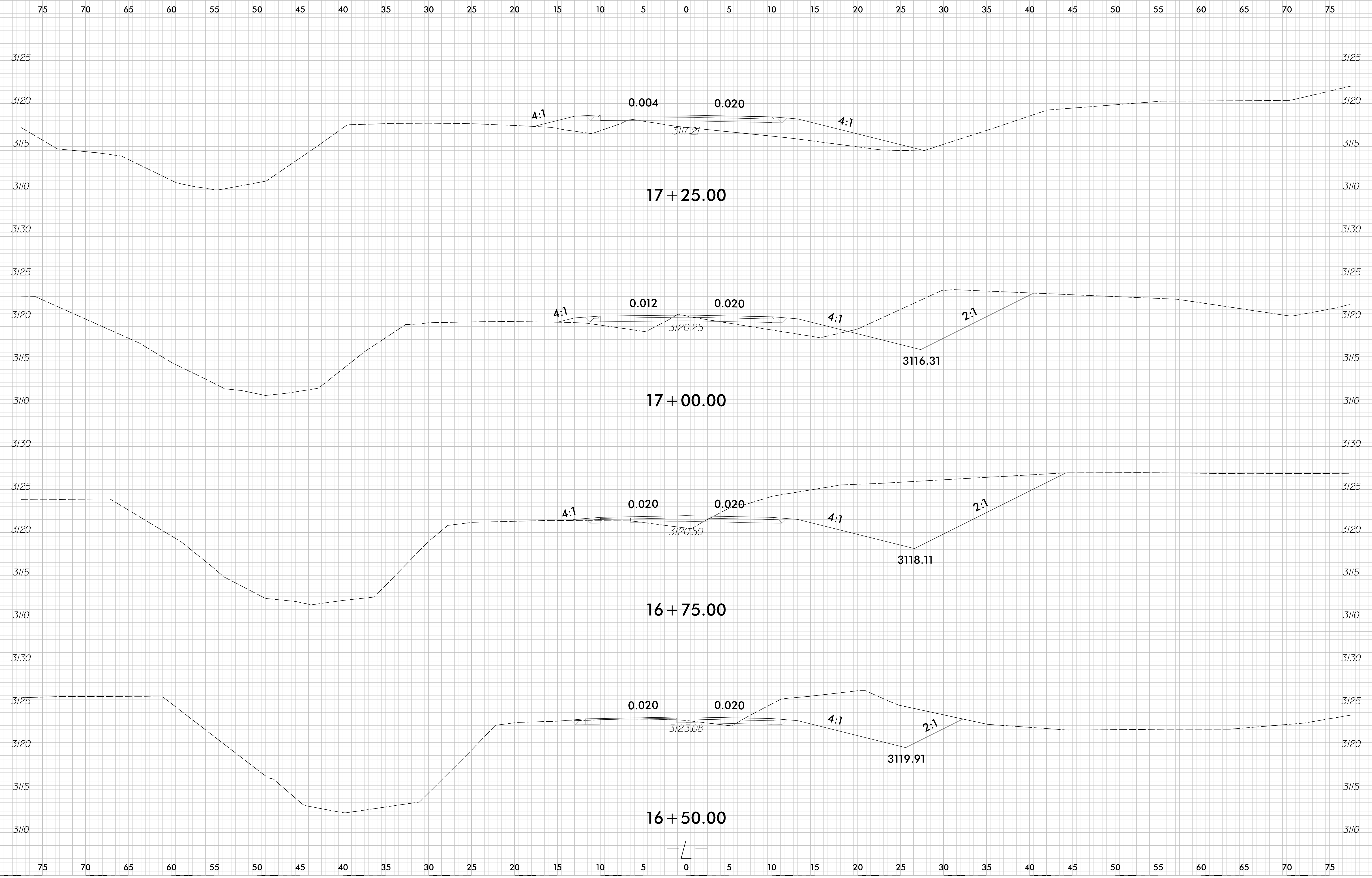

7/8/2019
C:\ProgramData\Bentley\MapDraw\CorridorModeling\17BP.R177.430237.rdy.XPL.L.dgn

6/23/16

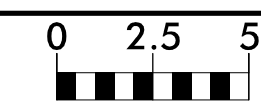

PROJ. REFERENCE NO.	SHEET NO.
17BP.14.R.177	X-8

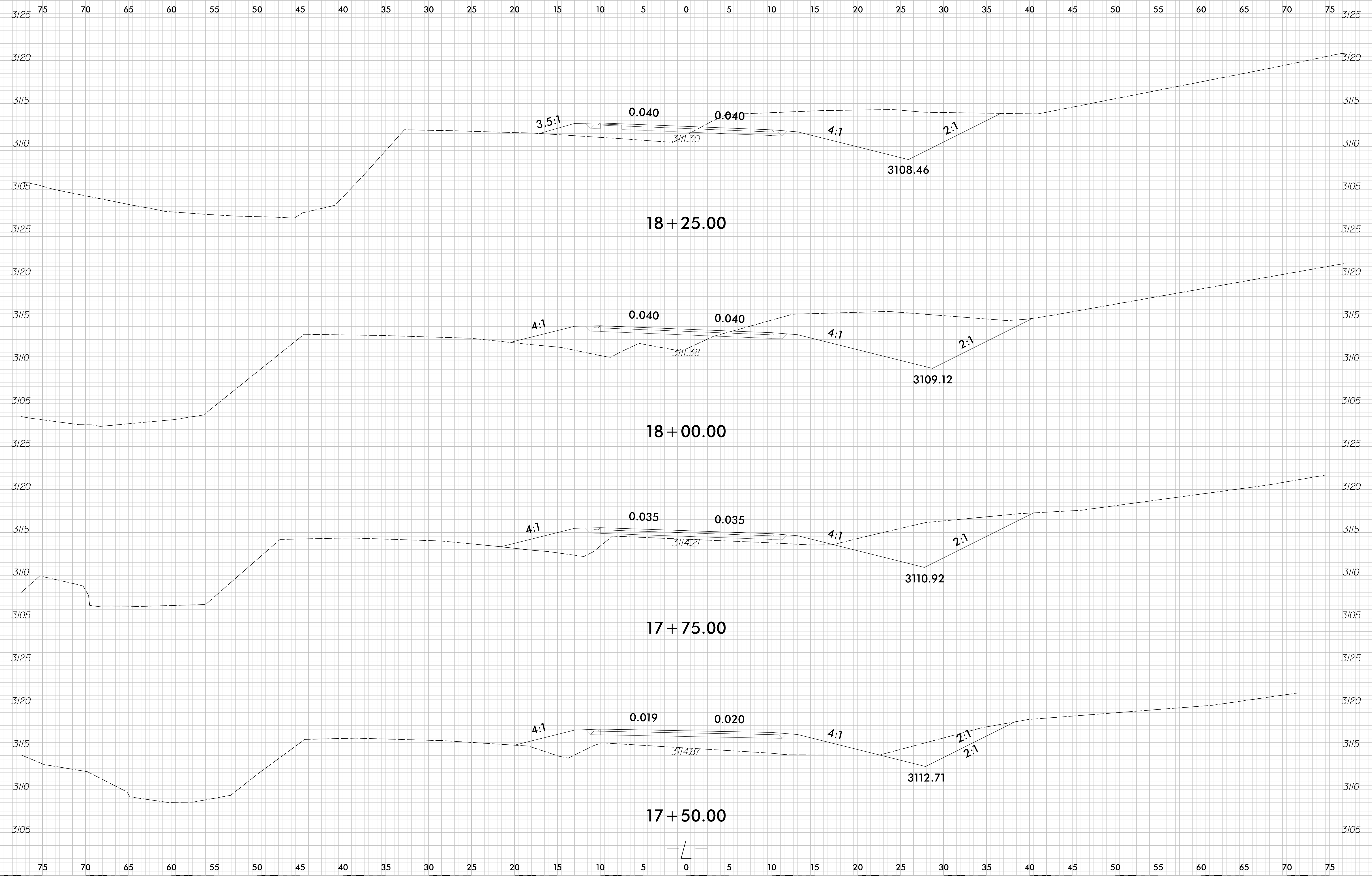

7/8/2019
D:\Projects\17BP.14.R.177\430237_rdy_XPL_L.dgn

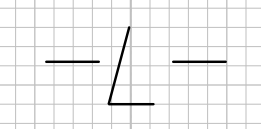

6/23/16

	PROJ. REFERENCE NO.	SHEET NO.
	17BP.14.R.177	X-9

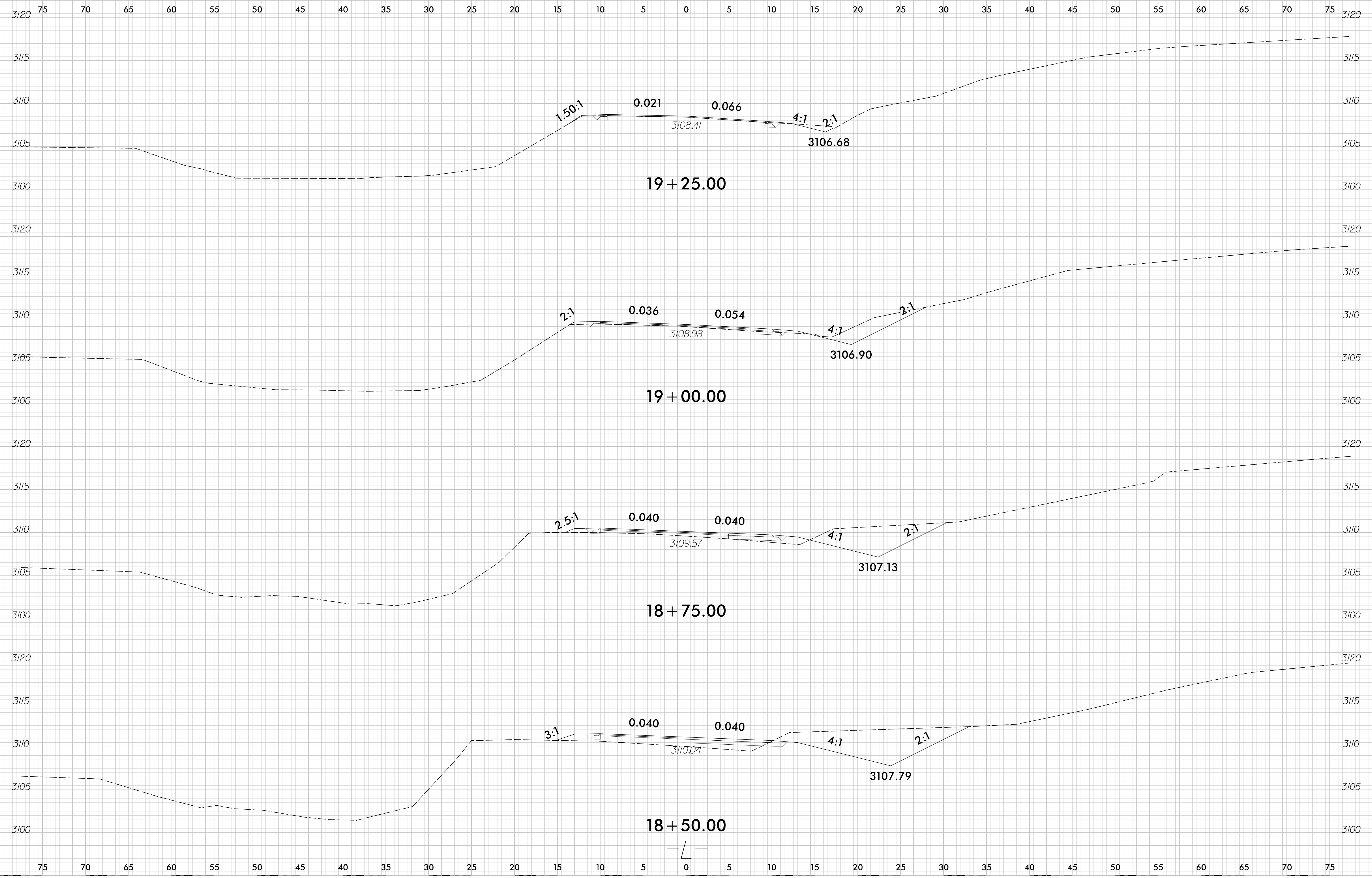

7/8/2019
\\Fs1\p02\rdg\Corridor-Modeling\17BP.R177.430237.rdy.XPL_L.dgn
10:04:40

6/23/16

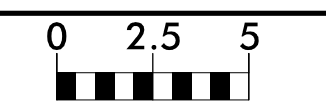

PROJ. REFERENCE NO.	SHEET NO.
17BP.14.R.177	X-10

75 70 65 60 55 50 45 40 35 30 25 20 15 10 5 0 5 10 15 20 25 30 35 40 45 50 55 60 65 70 75

7/8/2019
 I:\Projects\17BP.14.R.177\430237_rdy_XPL_L.dgn
 03:10:40

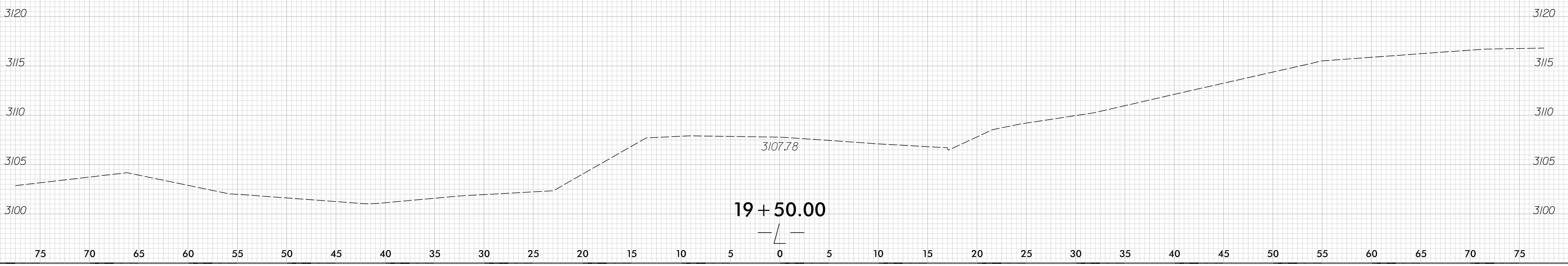

19 + 50.00

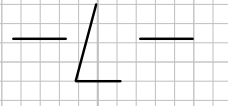

6/23/16

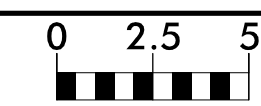

PROJ. REFERENCE NO.	SHEET NO.
17BP.14.R.177	X-11

75 70 65 60 55 50 45 40 35 30 25 20 15 10 5 0 5 10 15 20 25 30 35 40 45 50 55 60 65 70 75

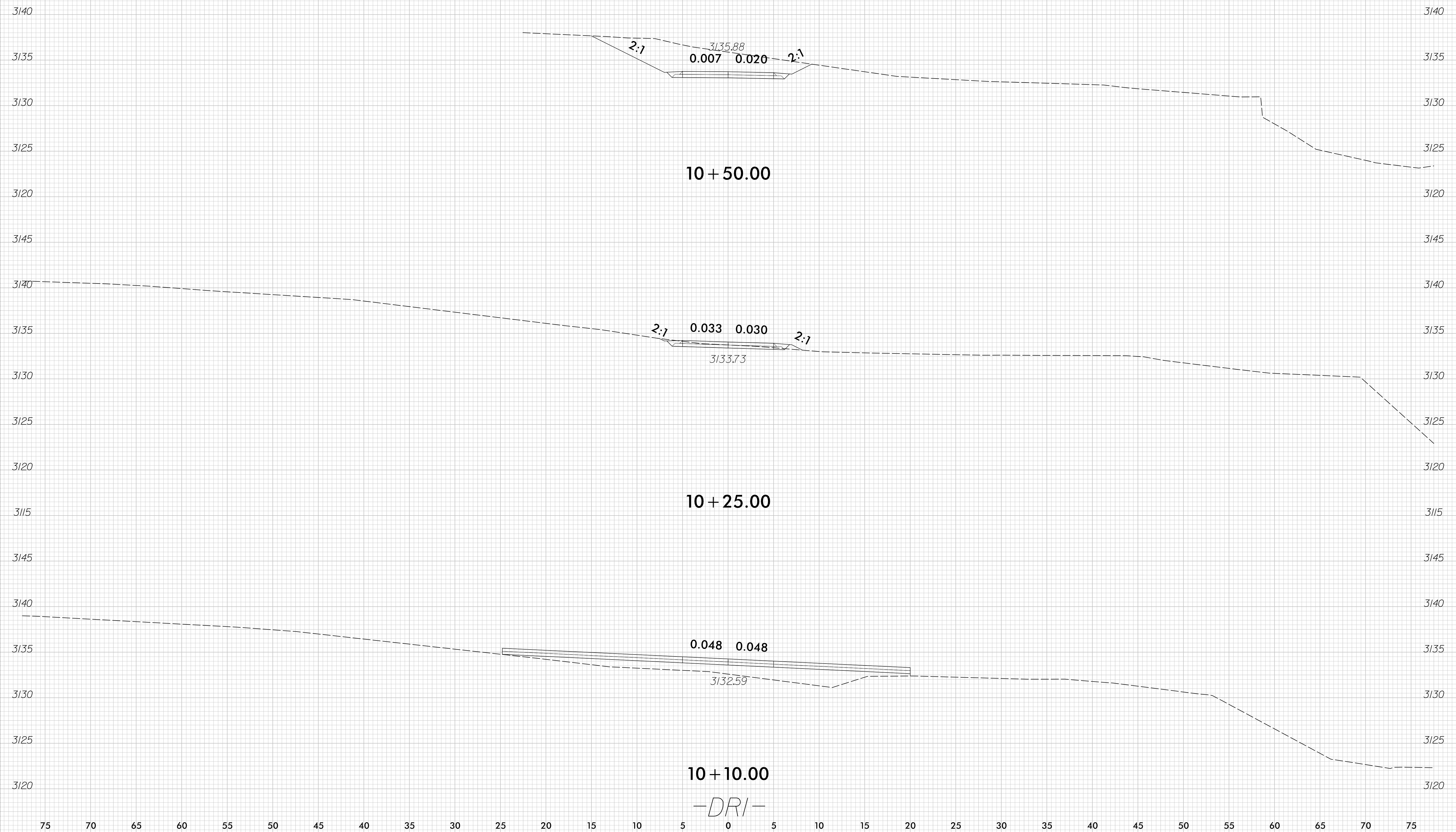

7/8/2019
 I:\Projects\17BP.14.R.177\430237_rdy_XPL_DRI.dgn
 10:04:40

75 70 65 60 55 50 45 40 35 30 25 20 15 10 5 0 5 10 15 20 25 30 35 40 45 50 55 60 65 70 75

6/23/16

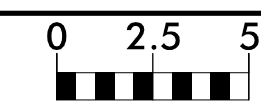

PROJ. REFERENCE NO.	SHEET NO.
17BP.14.R.177	X-12

75 70 65 60 55 50 45 40 35 30 25 20 15 10 5 0 5 10 15 20 25 30 35 40 45 50 55 60 65 70 75

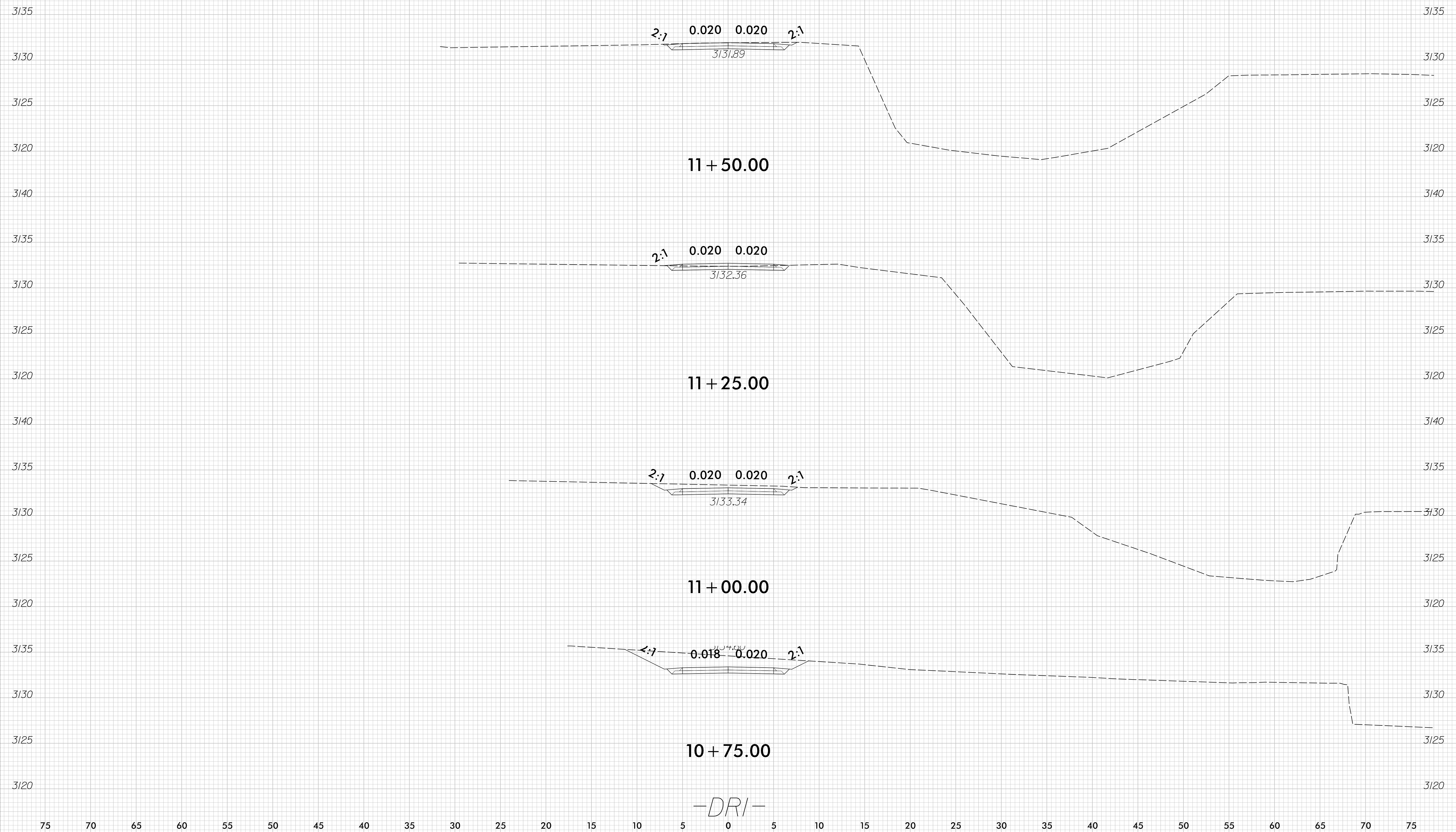

7/8/2019
 I:\Projects\17BP.14.R.177\430237_rdy_XPL_DRI.dgn
 10:24:40

6/23/16

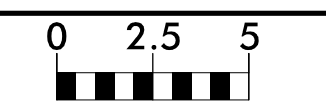

PROJ. REFERENCE NO.	SHEET NO.
17BP.14.R.177	X-13

75 70 65 60 55 50 45 40 35 30 25 20 15 10 5 0 5 10 15 20 25 30 35 40 45 50 55 60 65 70 75

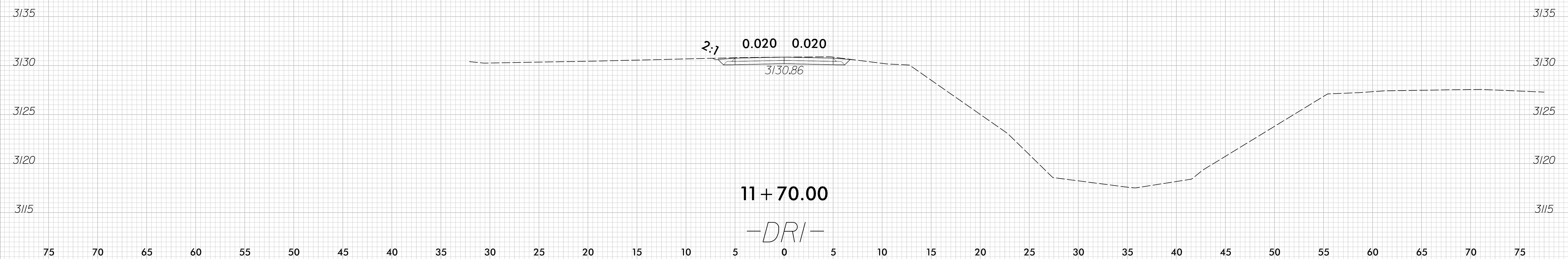

7/8/2019
 I:\Projects\17BP.14.R.177\430237_rdy_XPL_DRI.dgn
 10:04:40

6/23/16

	PROJ. REFERENCE NO.	SHEET NO.
	17BP.14.R.177	X-14

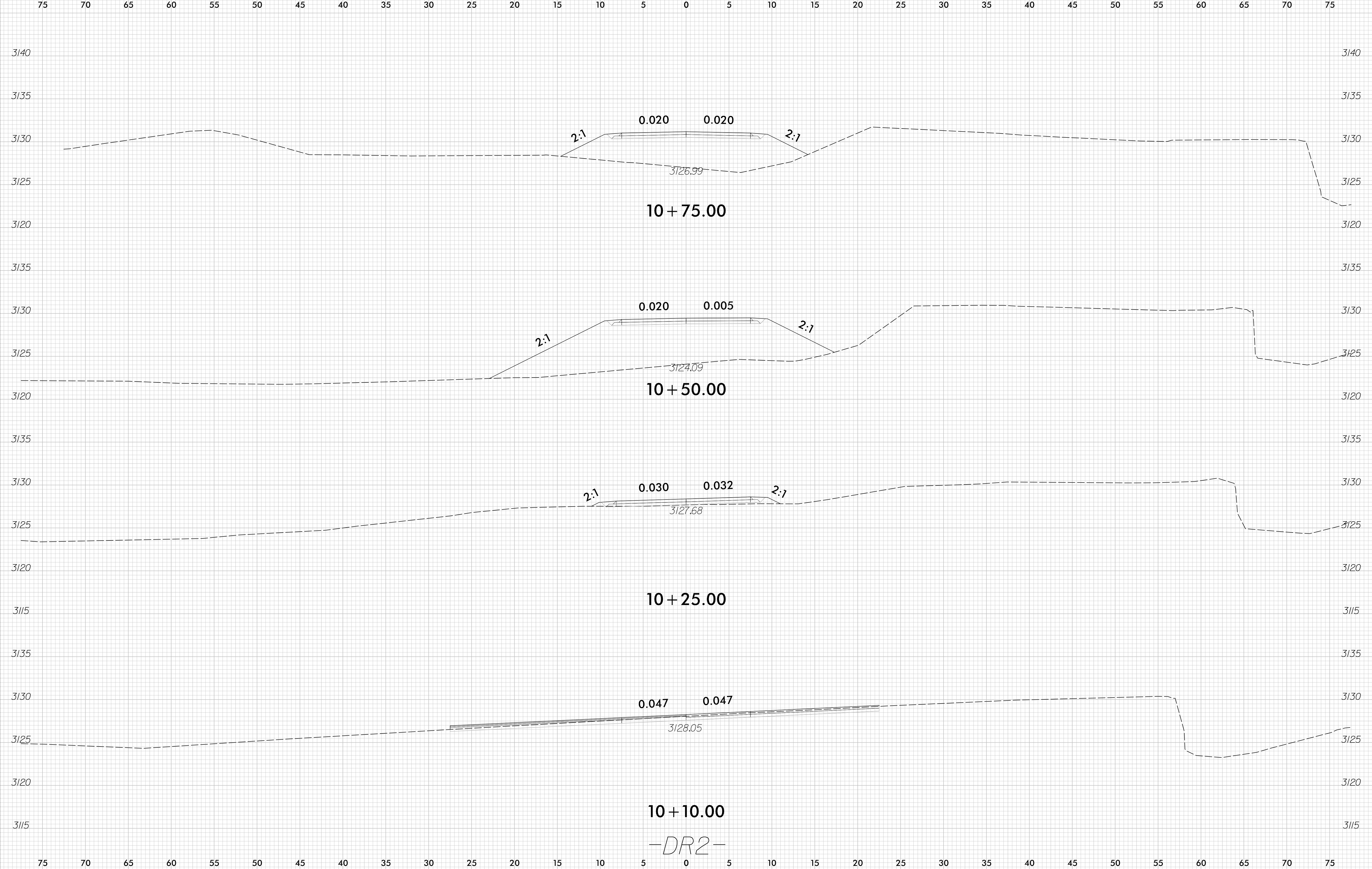

7/8/2019
D:\Projects\17BP.R177.430237.rdy\XPL_DR2.dgn

6/23/16

	PROJ. REFERENCE NO.	SHEET NO.
	17BP.14.R.177	X-15

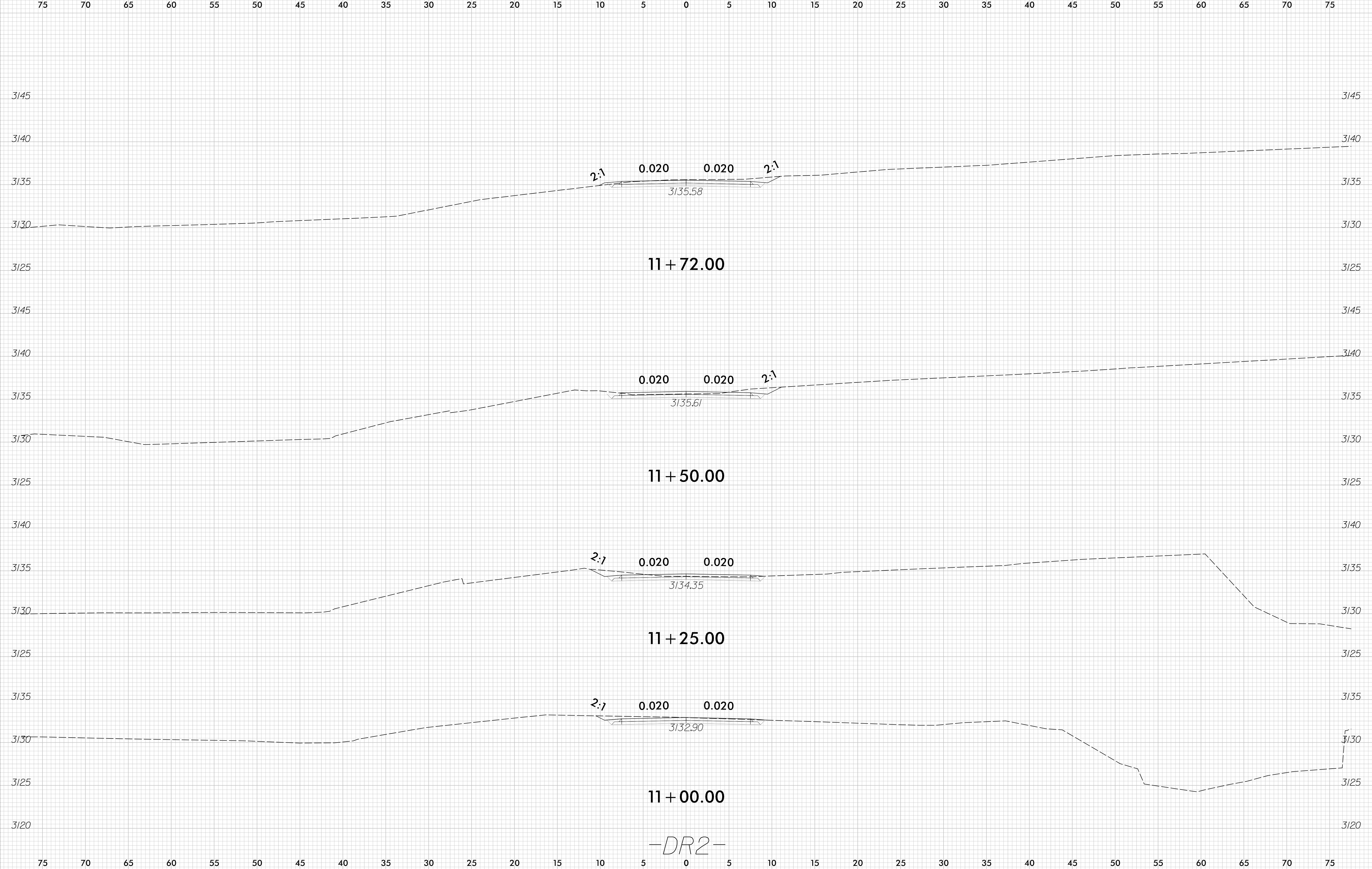

-DR2-

7/8/2019
D:\Projects\17BP.14.R.177\430237_rdy_XPL_DR2.dgn